

RIDGEFIELD PARK

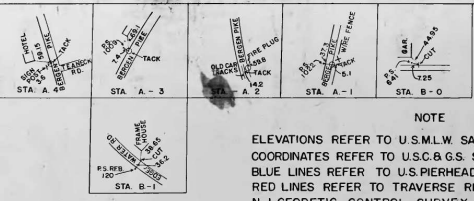

+ 2.35	MEAN HIGH WATER
0.0	MEAN SEA LEVEL SANDY HOOK
- 2.35	MEAN LOW WATER SANDY HOOK

NOTE
 ELEVATIONS REFER TO U.S.M.L.W. SANDY HOOK
 COORDINATES REFER TO U.S.C.B.G.S. STA. BOGART
 BLUE LINES REFER TO U.S. PIERHEAD & BULKHEAD LINES FROM HARBOR LINE MAPS OF 1921
 RED LINES REFER TO TRAVERSE RIPARIAN SURVEY
 N.J. GEODETIC CONTROL SURVEY COORDINATES FOR STA. BOGART ARE
 SOUNDINGS ARE IN FEET AND REFER TO MEAN LOW WATER
 NOT UNDERLINED ARE TRANSCRIBED FROM HARBOR MAPS OF 1921
 BEARINGS ARE BASED ON U.S. HARBOR LINES SURVEY GRID

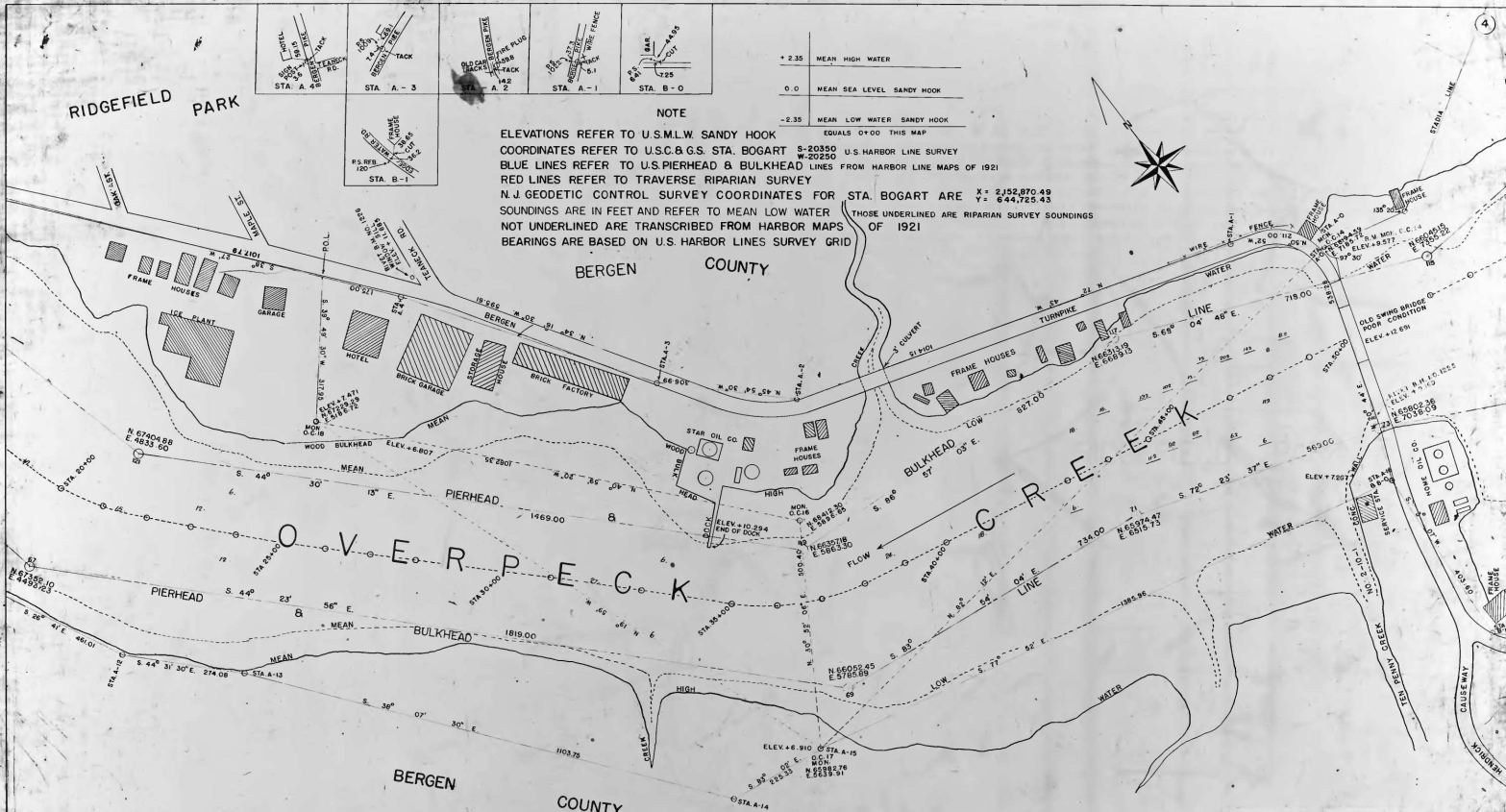

DESCRIPTIONS OF MONUMENTS

- O.C. 14 CONC. MON. WITH 2" PIPE IN CENTER ABOUT 1.0 FT ABOVE STONEWALL
- O.C. 16 CONC. MON. WITH 2" PIPE IN CENTER ABOUT 1.0 FT ABOVE GROUND
- O.C. 17 CONC. MON. WITH 2" PIPE IN CENTER ABOUT 1.5 FT ABOVE MEADOW AT H.W.
- O.C. 18 CONC. MON. WITH 2" PIPE IN CENTER FLUSH WITH GROUND

POOR CONDITION
 ELEV. 4.810
 ELEV. 4.810
 ELEV. 4.810

BORO. OF RIDGEFIELD

SIDE ELEVATION OLD SWING BRIDGE

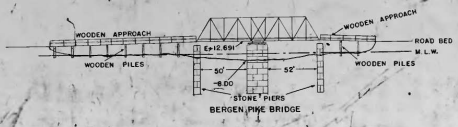

Ber 933
 DATE OF SURVEY - JAN. 1936 TO FEB. 1939
 W.P.A. NEW JERSEY
 J. P. HANCOCK & STREAM SURVEYING
 BERGEN COUNTY
 OVERPECK CREEK
 HACKENSACK RIVER
 NO. E-10
 1" = 100 FT
 APR 29 1936
Arthur J. Hancock