

CITY OF CAPE MAY CITY

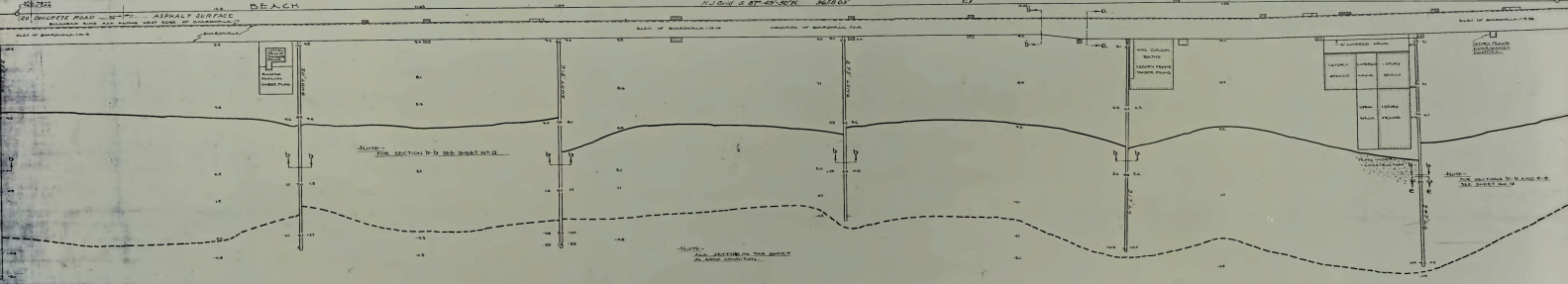

NOTE - SECTIONS TAKEN JUNE 24, 1933

ATLANTIC OCEAN

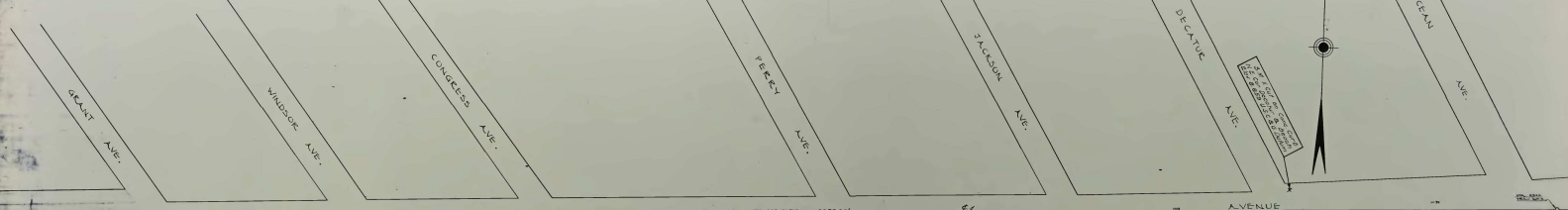
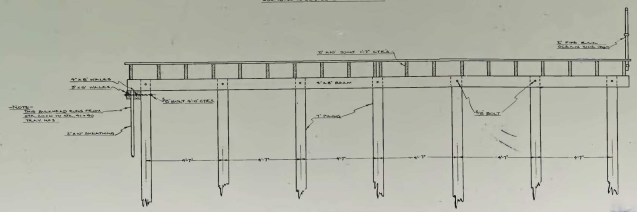
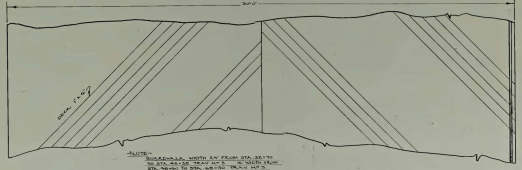

SECTION B-C
FROM STA. 10+00 TO STA. 10+50
SECTION D-E FROM STA. 10+50 TO STA. 11+00
CONSTRUCTION IN SECTION B-C IS BEARING ON PILES

 COLLECTED UNDER N.J.A.C.
 ENGINEER
 STATE ENGINEER
 COUNTY OF CAPE MAY
 PROJECT 1275
 SHEET NO. 34 OF 46
 DATE 1933