

PASSAIC COUNTY

BOROUGH OF TOTOWA

CITY OF PATERSON

C & G COORDINATES

STATION	Y	X
1510211.0	122 928.04	2 10041.24
1510212.0	123 433.05	2 10072.97
1510213.0	124 004.04	2 10127.04
1510214.0	124 575.37	2 10194.93
1510215.0	125 146.83	2 10277.12
1510216.0	125 717.14	2 10374.24
1510217.0	126 287.11	2 10485.87
1510218.0	126 856.06	2 10602.61
1510219.0	127 424.58	2 10734.99
1510220.0	127 992.00	2 10882.54
1510221.0	128 558.98	2 11045.79
1510222.0	129 125.00	2 11224.28
1510223.0	129 690.50	2 11418.56
1510224.0	130 255.00	2 11628.28
1510225.0	130 818.50	2 11853.00
1510226.0	131 381.00	2 12093.44
1510227.0	131 942.50	2 12349.24
1510228.0	132 503.00	2 12620.00
1510229.0	133 062.50	2 12906.44
1510230.0	133 621.00	2 13208.24
1510231.0	134 178.50	2 13525.00
1510232.0	134 735.00	2 13857.44
1510233.0	135 290.50	2 14205.24
1510234.0	135 844.50	2 14568.00
1510235.0	136 397.00	2 15045.44
1510236.0	136 948.50	2 15538.24
1510237.0	137 498.50	2 16046.00
1510238.0	138 046.50	2 16569.44
1510239.0	138 593.00	2 17108.24
1510240.0	139 137.50	2 17662.00
1510241.0	139 680.00	2 18230.44
1510242.0	140 220.50	2 18814.24
1510243.0	140 758.50	2 19413.00
1510244.0	141 294.00	2 20027.44
1510245.0	141 827.00	2 20657.24
1510246.0	142 357.50	2 21302.00
1510247.0	142 885.00	2 21962.44
1510248.0	143 410.00	2 22638.24
1510249.0	143 932.00	2 23329.00
1510250.0	144 451.50	2 24035.44
1510251.0	144 968.50	2 24757.24
1510252.0	145 483.00	2 25494.00
1510253.0	145 994.50	2 26246.44
1510254.0	146 503.00	2 27014.24
1510255.0	147 008.50	2 27797.00
1510256.0	147 511.00	2 28594.44
1510257.0	148 010.50	2 29406.24
1510258.0	148 507.00	2 30232.00
1510259.0	149 000.50	2 31072.44
1510260.0	149 491.00	2 31927.24
1510261.0	149 978.50	2 32797.00
1510262.0	150 463.00	2 33681.44
1510263.0	150 944.50	2 34580.24
1510264.0	151 422.00	2 35494.00
1510265.0	151 896.50	2 36422.44
1510266.0	152 367.50	2 37365.24
1510267.0	152 835.00	2 38323.00
1510268.0	153 300.00	2 39295.44
1510269.0	153 761.50	2 40282.24
1510270.0	154 219.50	2 41284.00
1510271.0	154 674.00	2 42300.44
1510272.0	155 125.00	2 43332.24
1510273.0	155 572.50	2 44379.00
1510274.0	156 016.50	2 45440.44
1510275.0	156 457.00	2 46517.24
1510276.0	156 894.00	2 47609.00
1510277.0	157 327.50	2 48715.44
1510278.0	157 757.50	2 49837.24
1510279.0	158 184.00	2 50974.00
1510280.0	158 607.00	2 52125.44
1510281.0	159 026.50	2 53291.24
1510282.0	159 442.50	2 54472.00
1510283.0	159 855.00	2 55667.44
1510284.0	160 264.00	2 56878.24
1510285.0	160 669.00	2 58104.00
1510286.0	161 070.00	2 59345.44
1510287.0	161 467.00	2 60602.24
1510288.0	161 860.00	2 61875.00
1510289.0	162 249.00	2 63163.44
1510290.0	162 634.00	2 64467.24
1510291.0	163 015.00	2 65786.00
1510292.0	163 392.00	2 67120.44
1510293.0	163 765.00	2 68470.24
1510294.0	164 134.00	2 69835.00
1510295.0	164 499.00	2 71215.44
1510296.0	164 860.00	2 72611.24
1510297.0	165 217.00	2 74023.00
1510298.0	165 570.00	2 75450.44
1510299.0	165 919.00	2 76893.24
1510300.0	166 264.00	2 78352.00

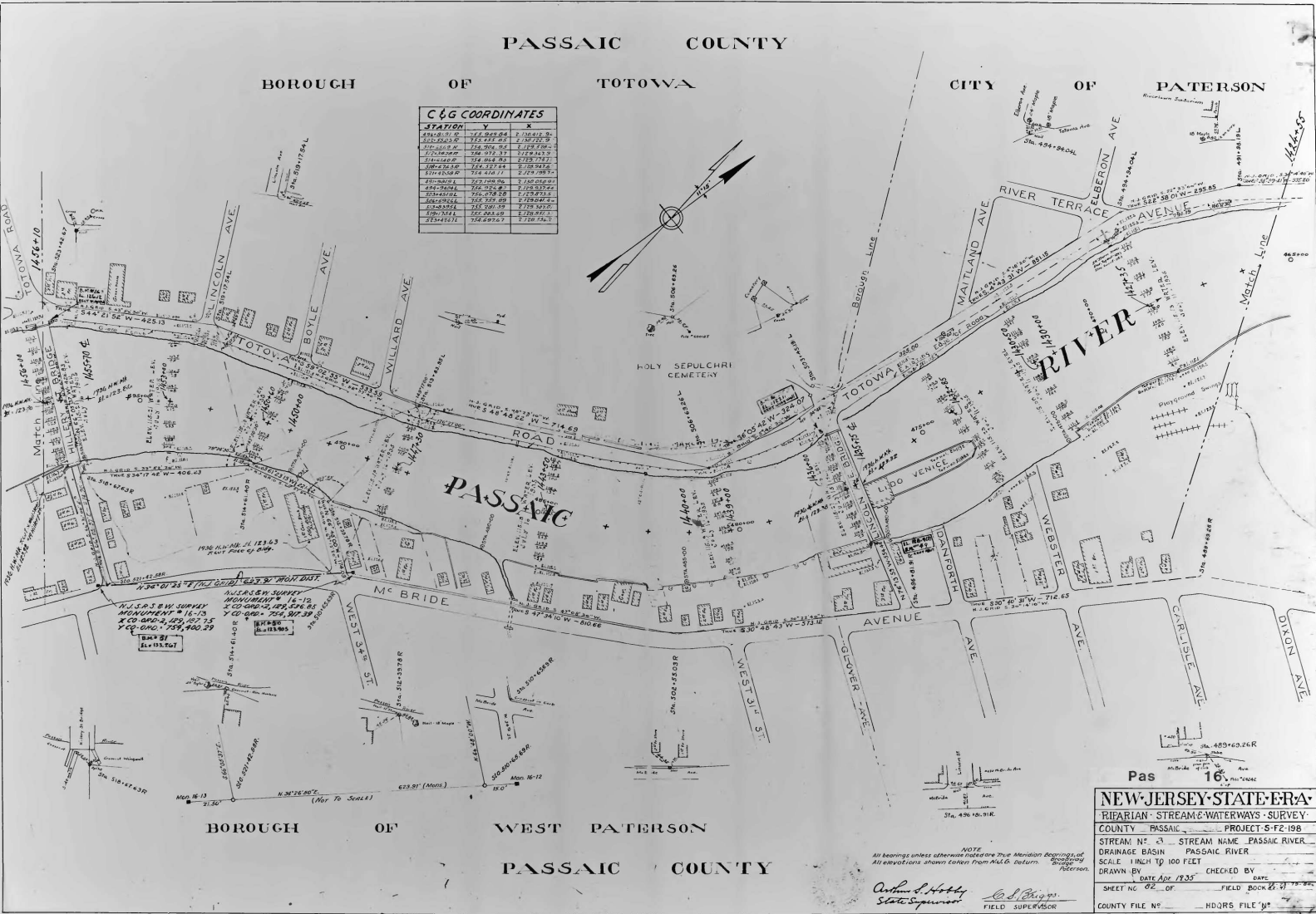

BOROUGH OF WEST PATERSON

PASSAIC COUNTY

Pas 16

**NEW JERSEY STATE ENGINEERS**  
**RIPARIAN - STREAM & WATERWAYS - SURVEY**  
 COUNTY - PASSAIC - PROJECT - S-FZ-198  
 STREAM NO. 3 - STREAM NAME - PASSAIC RIVER  
 DRAINAGE BASIN - PASSAIC RIVER  
 SCALE - 1 INCH TO 100 FEET  
 DRAWN BY - DATE - Apr. 1935 - CHECKED BY -  
 SHEET NO. 02 OF FIELD BOOK NO. 13-1935  
 COUNTY FILE NO. - HQRS FILE NO.

NOTE  
 All bearings unless otherwise noted are True Meridian Bearings of  
 All elevations shown taken from M.L.D. datum.  
 C. H. H. H. H.  
 State Engineer  
 F. L. B. B. B.  
 FIELD SUPERVISOR