

PASSAIC COUNTY
BOROUGH OF TOTOWA

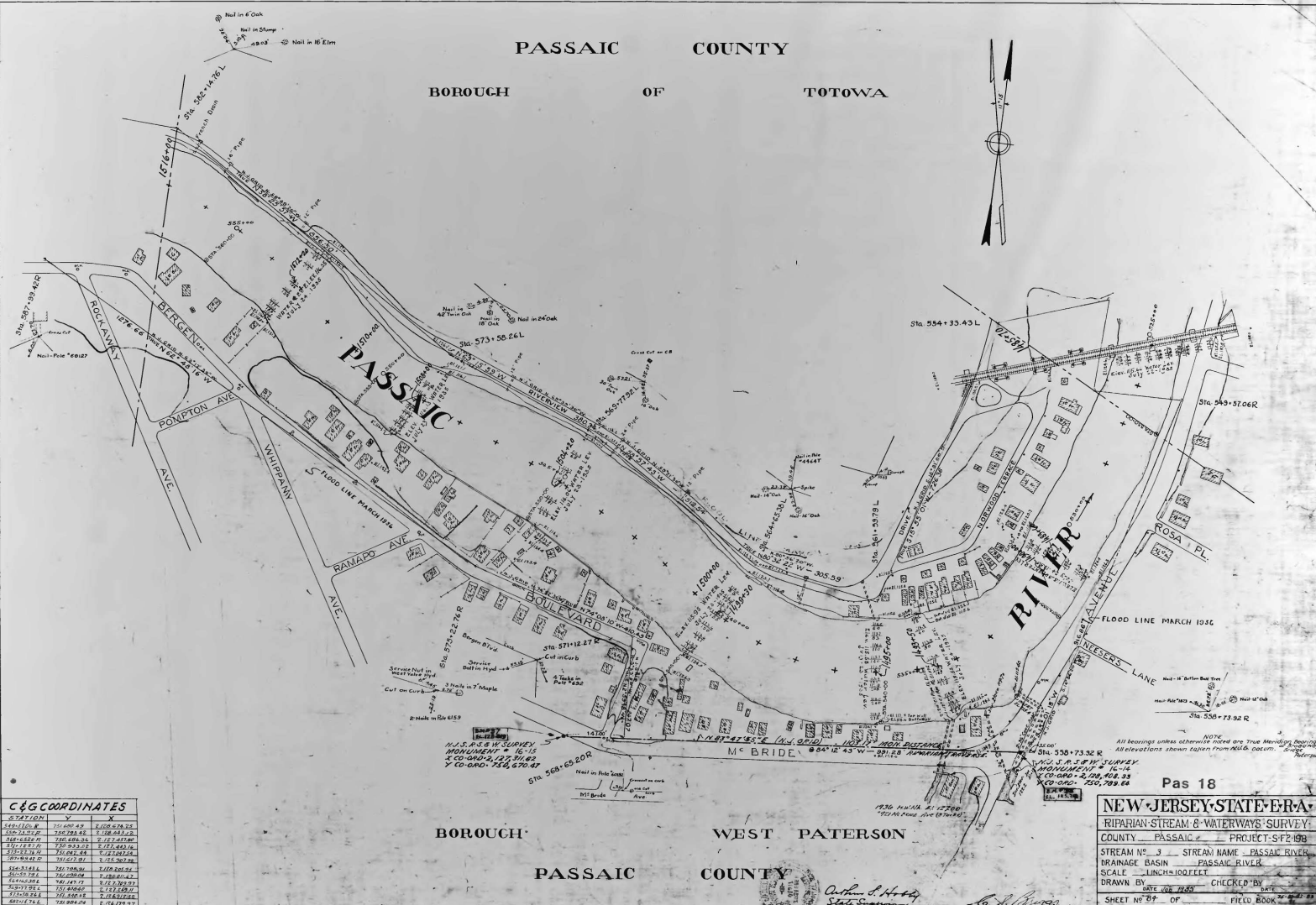

C & G COORDINATES

STATION	Y	X
552+1470 L	111,000.00	1,100,000.00
553+00.00 L	111,000.00	1,100,000.00
554+00.00 L	111,000.00	1,100,000.00
555+00.00 L	111,000.00	1,100,000.00
556+00.00 L	111,000.00	1,100,000.00
557+00.00 L	111,000.00	1,100,000.00
558+00.00 L	111,000.00	1,100,000.00
559+00.00 L	111,000.00	1,100,000.00
560+00.00 L	111,000.00	1,100,000.00
561+00.00 L	111,000.00	1,100,000.00
562+00.00 L	111,000.00	1,100,000.00
563+00.00 L	111,000.00	1,100,000.00
564+00.00 L	111,000.00	1,100,000.00
565+00.00 L	111,000.00	1,100,000.00
566+00.00 L	111,000.00	1,100,000.00
567+00.00 L	111,000.00	1,100,000.00
568+00.00 L	111,000.00	1,100,000.00
569+00.00 L	111,000.00	1,100,000.00
570+00.00 L	111,000.00	1,100,000.00

NOTE:
All bearings unless otherwise noted are True Meridian bearings.
All elevations shown unless noted are from MLLG datum.

BOROUGH OF WEST PATERSON
PASSAIC COUNTY

Pas 18

NEW JERSEY STATE ENGINEERING
 RIPARIAN-STREAM & WATERWAYS SURVEY
 COUNTY — PASSAIC — PROJECT-SF2178
 STREAM NO. 3 — STREAM NAME — PASSAIC RIVER
 DRAINAGE BASIN — PASSAIC RIVER
 SCALE — 1 INCH=100 FEET
 DRAWN BY — DATE — 106 7285 — CHECKED BY —
 SHEET NO. 87 OF — FIELD BOOK —
 COUNTY FILE NO. — HDHS FILE NO. —

Arthur C. Harty
State Engineer

W. A. Ganga
FIELD SUPERVISOR