

U.S. COAST & GEOD. SURV. LEVEL ADJUSTMENT
 N.J. STATE PLANE COORDINATES
 X COORDINATE 833,000.02
 Y COORDINATE 133,000.02
 STATION - LOVELAND ECCENTRIC

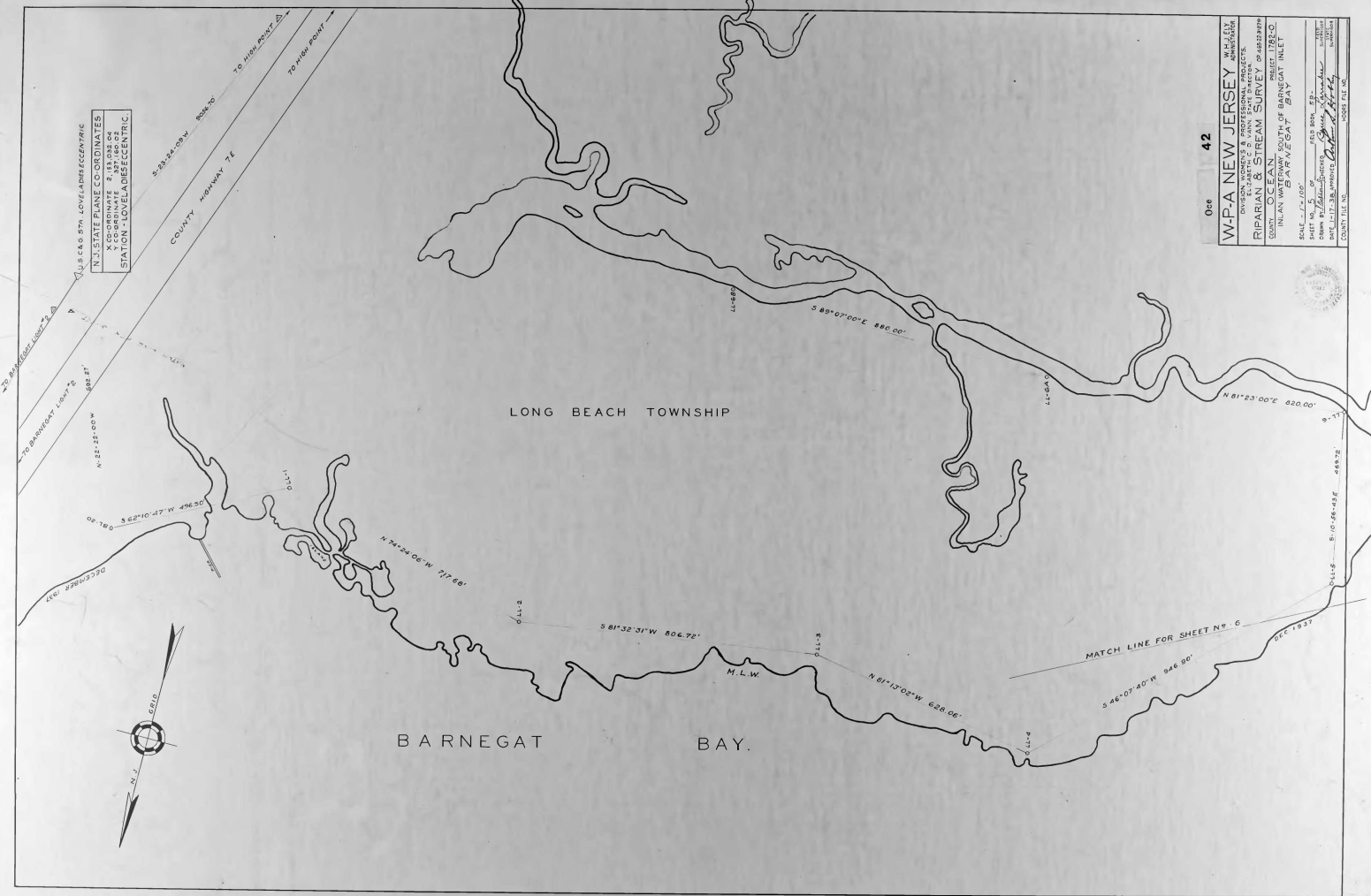

0cs 42
W.P.A. NEW JERSEY
 DIVISION OF LAND & CONSERVATION
 RIPARIAN & STREAM SURVEY PRODUCTS
 SOUTH OCEAN COUNTY OF BARNEGAT INLET
 BARNEGAT BAY
 SCALE - 1/2" = 100'
 SHEET NO. 42 OF 42
 DATE OF SURVEY 10/10/00
 COUNTY FILE NO. 000874E

