

Superseding Map No. 52 of October 15, 1937. Please destroy old issue.

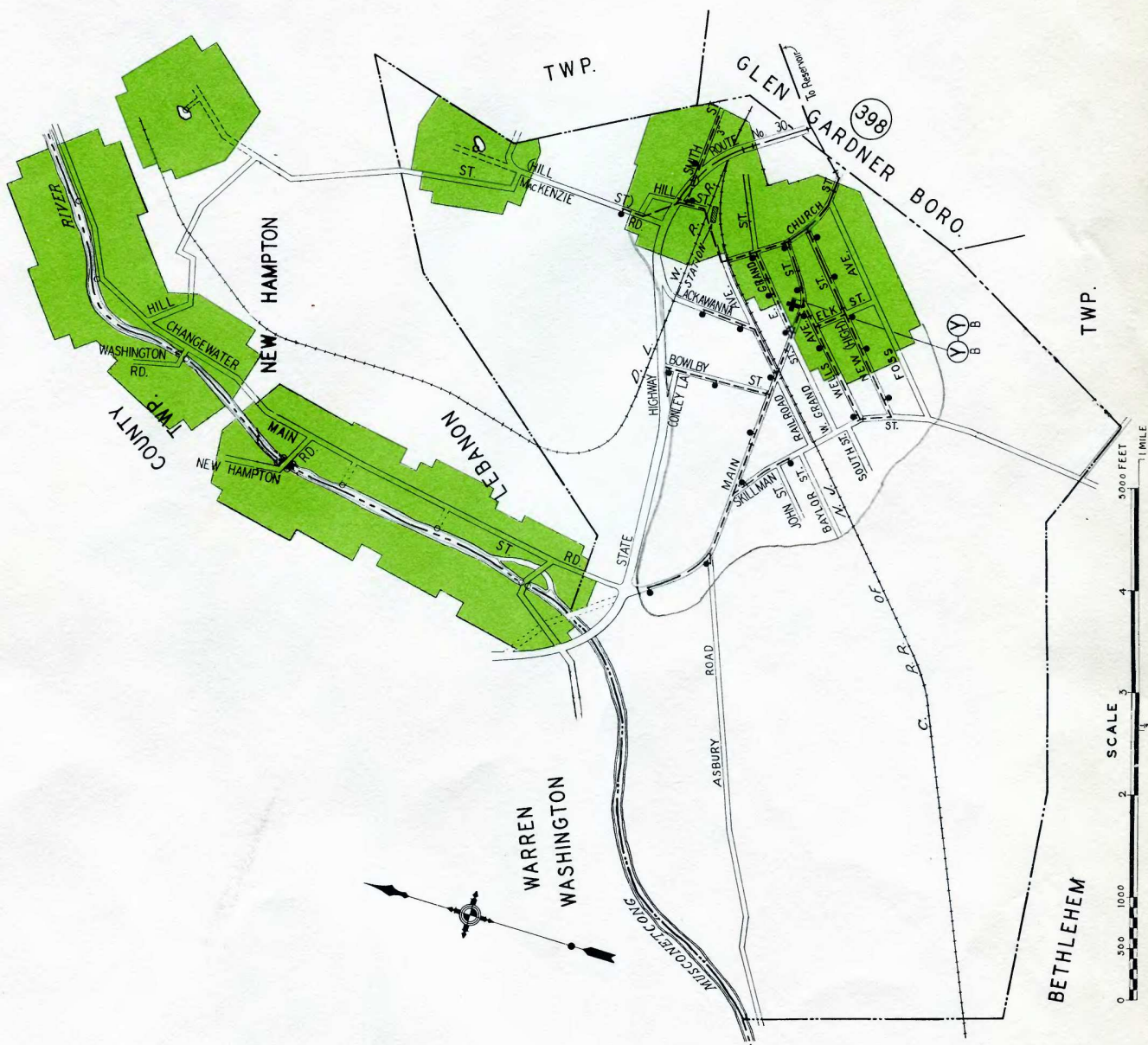

KEY

PROTECTED FIRE ZONE: Shown in Green.

NOTE. — Fire protection report on file in Engineering Department of F. I. R. O. of N. J.

Elevations range from 340 to 780 feet above mean sea level.

Water mains 8 inches and larger in diameter

Water mains 6 inches in diameter

Water mains 4 inches in diameter

Fire hydrants shown thus

Gate valves shown thus

Fire house shown thus

Fire apparatus designated by symbols thus:

(Y) Pumping engine and hose car

(O) Booster tank or tanks on above

THE FIRE INSURANCE RATING
ORGANIZATION OF N. J.

ENGINEERING DEPARTMENT
NEWARK 2, N. J.

Hampton Borough
Hunterdon County, New Jersey

JUNE 14, 1952

October 15, 1937.

BOROUGH OF HAMPTON, HUNTERDON COUNTY, NEW JERSEY.

Population—Census of 1930 was 861.

IN GENERAL: Located on the C. R. R. of N. J. about four miles west of High Bridge. There is a creamery and a small plant, and a number of employees of the steel plant in High Bridge live here. Area about 1.3 square miles. Elevations range from 340 to 780. Main thoroughfares paved, others cindered or graveled in fair condition. No railroad crossings at grade.

WATER SUPPLY: The Junction Water Company owns and operates the supply works and distribution system and supplies water for domestic and fire protection purposes to Hampton only. Works built about 1898. Repair and maintenance work done by man from Washington, four miles distant. Records only fair. **Supply Works:** Supplied by gravity through a 6-in. pipe from reservoir $1\frac{1}{2}$ miles east of borough line. Reservoir supplied by group of springs and by an 8-in. well 110 ft. deep operated by air. Yield of well and springs is about 200,000 gallons per day, but yield drops considerably during dry weather. There is an additional reservoir in the borough, but it is too low for distribution purposes and is used for filling railroad tank only. **Pumping Station:** Located at reservoir; 1 story frame, iron clad building with concrete floor, heat from engine exhaust, lanterns for light, oil for fuel in 50-gallon buried tank and several full drums on hand. **Equipment:** One Fairbanks-Morse 15-h.p. oil engine driving an 8-in. x 6-in. Pennsylvania air compressor; capacity about 100 g.p.m. Well is operated almost continuously. Elevation of floor about 682. **Consumption:** During 1936 the average daily consumption was 78,000 gallons. **Distribution System:** In one service; see map. **Pipe:** All cast iron, tar coated, with bell and spigot joint laid with $3\frac{1}{2}$ -ft. cover. Some trouble from frozen mains. Total length 17,834 ft.; 32% 6-in., 68% 4-in. **Gate Valves:** 17 on system of Rensselaer make usually set with iron box at grade. No inspections made. Fire department notified when valves affecting hydrant supply are operated. **Hydrants:** 26 of Corey and Ludlow makes; all have two $2\frac{1}{2}$ -in. outlets and one has a $4\frac{1}{2}$ -in. outlet in addition. Hydrants have 6-in. barrels and 4-in. branch, 3 of which are gated. Hydrants inspected twice annually. Those operated were in fairly good condition. **Pressures:** Readings taken at 5 well distributed hydrants showed pressures ranging from 50 to 135 pounds with an average of 88.6 pounds. **Fire Flow Tests:** Probable supply available for fire protection purposes was measured on June 29th, 1937, by means of Pitot tube. Location of hydrant, discharge in gallons per minute, pressure before flow and pressure during flow were as follows:

Main and East Grand Sts., 220—73—22.

New St., between Skillman and Elk Sts. (South St.), 130—50—0.

New and Skillman Sts., 90—*—*.

New and South Sts., 210—*—*.

Wells Ave. and Skillman St., 180—*—*.

Last hydrant on Smith St., 50—55—*.

Smith St. and State Highway, 150—*—*.

Bowlby St. and State Highway, 140—*—*.

Next to last hydrant on Bowlby St., 140—*—*.

Main St. and Highway, 120—130—*.

Main St. and Asbury Rd., 150—135—*.

Main and Skillman Sts., 220—*—*.

* No reading taken.

FIRE DEPARTMENT: Volunteer organization under partial control of the borough. Officers elected by company for one year term; chief officers' election confirmed by Mayor and Council. Borough owns house, apparatus and equipment. Total membership 30 including chief, assistant chief and two foremen; about 12 to 15 members are available at all times. **Fire Station:** Located on Main St. opposite Wells Ave. in a 2-story frame building with slate roof, wood floor, steam heat, electric lights and siren. **Apparatus:** A 500 g.p.m. Sanford equipped with 750 ft. of $2\frac{1}{2}$ -in. hose, 150-gallon booster tank, 200 ft. of booster hose and little minor equipment. A 300-g.p.m. Obenchain-Boyer-Hale-Reo engine equipped with 450 ft. of $2\frac{1}{2}$ -in. hose, 40-gallon booster tank, 150 ft. of booster hose and little minor equipment. **Hose:** All $2\frac{1}{2}$ -in. hose is C. R. L. with screw couplings. It is said to be tested monthly at 190 pounds; it is dried on sidewalk. There is none in reserve. **Operations:** Governed by company by-laws. Chief has control of apparatus at all times and of men at fires and drills. **Drills and Training:** Drills are held monthly. **Response to Alarms:** All apparatus responds. Aid may be secured from High Bridge, Clinton and Washington. **Building Inspection:** None. **Reports and Records:** Monthly reports made to Mayor and Council and minutes of meetings kept by secretary. **Fire Alarms:** There are 8 boxes distributed for sounding coded signals on siren. Telephone alarms are received at house next door or at filling station where a member works.

POLICE DEPARTMENT: One uniformed officer available for duty when called.

BUILDING LAWS: None.

EXPLOSIVES AND FLAMMABLES: No municipal regulations. State law regulates the sale of fireworks to licensed operators.