

Superseding Map No. 239 of March 31, 1947. Please destroy old issue.

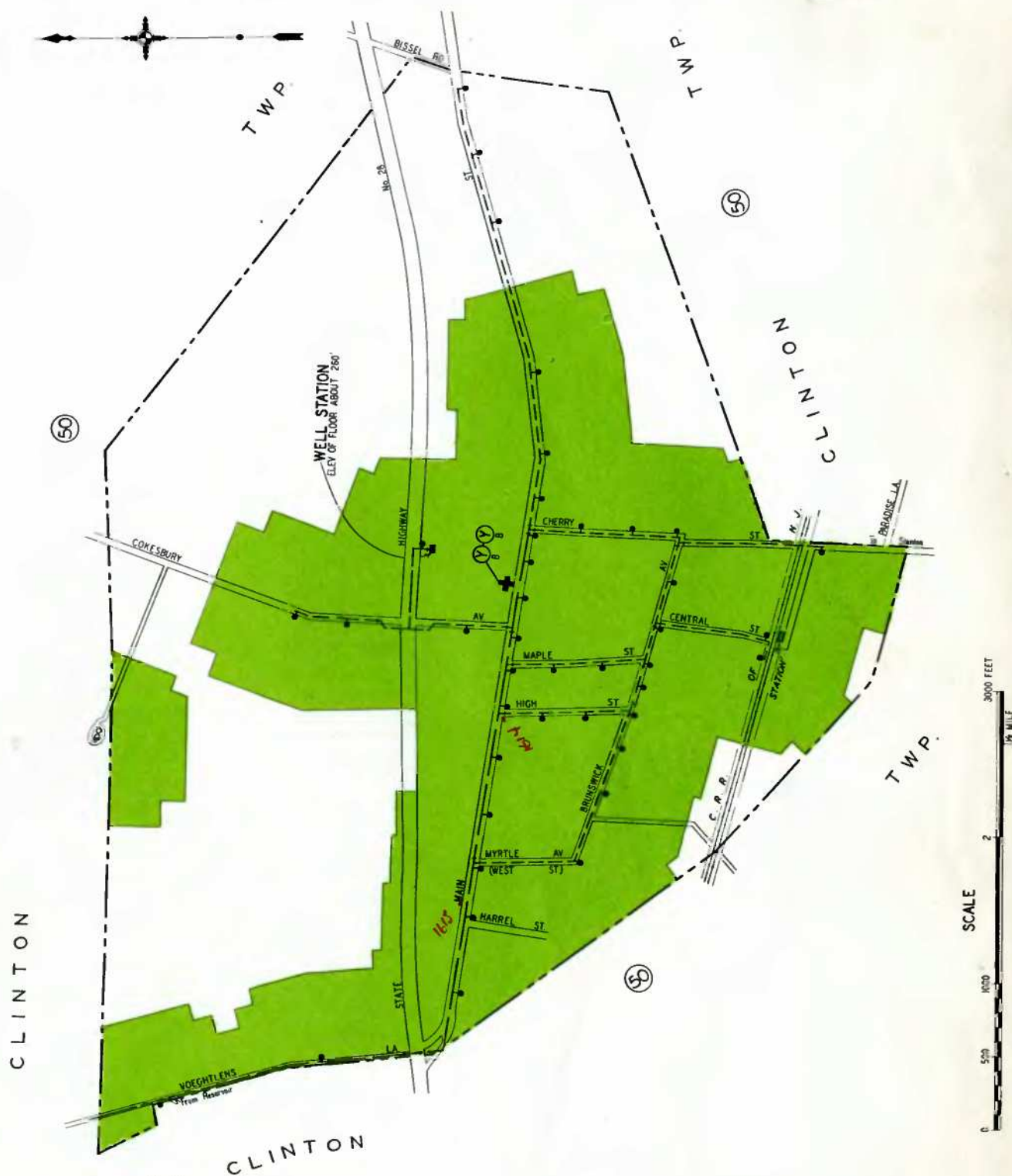

KEY

PROTECTED FIRE ZONE: Shown in Green.

NOTE.— Fire protection report on file in Engineering Department of F. I. R. O. of N. J.

Elevations range from 220 to 420 feet above mean sea level.

Water mains 8 inches and larger in diameter

Water mains 6 inches in diameter

Water mains 4 inches in diameter

Fire hydrants shown thus

Gate valves shown thus

Fire house shown thus

Fire apparatus designated by symbols thus:

(Y) Pumping engine and hose car

Q Booster tank or tanks on above

THE FIRE INSURANCE RATING
ORGANIZATION OF N. J.
ENGINEERING DEPARTMENT
NEWARK 2, N. J.

Lebanon Borough
Hunterdon County, New Jersey

JULY 31, 1952

LEBANON BOROUGH, HUNTERDON COUNTY, NEW JERSEY.

Population—1940 Census—638.

IN GENERAL: Located on the Central Railroad of New Jersey and on the New Jersey State Highway Route No. 28 about 14 miles west of Somerville. It is a residential community and agricultural area with no manufacturing except a few small industries connected with the dairying activities. Area about 0.93 square miles. Elevations range from 240 to 360 feet. Main thoroughfares are concrete or macadam in good condition. Some secondary streets are gravel in fair condition. One railroad crossing is such that it should not interfere with the response of fire apparatus, and other conditions are such that there should be no unusual delays in the response and operation of the fire department.

WATER SUPPLY: The Beaver Brook Water Company owns and operates the supply works and distribution system and appurtenances, supplying water for domestic and fire protection purposes to Clinton, Lebanon, and Annandale. The Lebanon supply is delivered through a single unsupported 6-inch main extending 8,170 feet from the reservoir to the west end of Main Street. For details as to organization, supply works, and appurtenances see report on Clinton with map No. 49. **Distribution System:** In one service consisting of wide 4-inch and 6-inch gridiron in center and 4-inch dead ends to outlying areas. **Consumption:** The average daily consumption in the entire territory served during 1945 was 0.183 m.g.d., of which 86.8%, as measured by Venturi meter at distributing reservoir, was delivered from the gravity system while the balance was pumped from the deep well station on State Highway No. 28 near Cokesbury Avenue in Lebanon. At time of inspection there were 644 services in the entire territory served, 182 of which were located in Lebanon. Services are generally unmetered. **Pipe:** All cast iron, tar coated, bell and spigot joint, laid with about a 3½-foot cover. No serious trouble reported from frozen mains or electrolysis, but considerable tuberculation has been experienced. Total length, 19,950 feet; 39.6% 6-inch and 60.4% 4-inch. **Gate Valves:** There are 21 on the system in Lebanon of R. D. Wood make set with iron boxes at or below grade. Direction of operation is uniform and valves are operated only as required by system maintenance. **Hydrants:** There are 39 on the system of R. D. Wood make of standard type with two 2½-inch outlets and 4-inch gated branches. Hydrant hose outlets are National Standard and no large outlets are provided. Hydrants are serviced and inspected about twice annually and were found to be in good condition at time of inspection. **Pressures:** Pressure recording gauge in company office at Clinton at about elevation 200 shows pressures to be fairly well maintained between 110 and 140 pounds, and showed a pressure of 115 pounds in midafternoon at time of inspection. Readings taken at 3 well distributed hydrants showed pressures ranging from 100 to 118 pounds with an average of 109.3 pounds. **Fire Flow Tests:** Probable supply available for fire protection purposes was measured on July 10, 1940 by means of Pitot tube. Location of hydrant, discharge in gallons per minute, pressure before flow, and pressure during flow were as follows:

Main St. and Cokesbury Ave., 340—110—14.

Main St. 600 ft. W. of Bissel Rd., 170—118—3.

Central St. and railroad, 210—100—10.

FIRE DEPARTMENT: A volunteer organization of one company under partial control of the bor-

ough which owns the smaller pumping engine and equipment and appropriates about \$600 each year for the support of the department. The company owns the larger pumping engine and the fire station. Total active membership 25 including the chief and 2 assistant chiefs, of whom a minimum of about 9 members are available at all times. Officers are elected annually by the company and confirmed by the mayor and council. **Company—Lebanon Volunteer Fire Company No. 1:** Located on Main Street east of Cokesbury Road as shown on map. Building is a 2-story concrete block and masonry structure with asbestos shingled wood roof, concrete apparatus floor, hot water heat, electric lights, and siren. **Equipment:** One 1940 American La France-Ford 500-g.p.m. triple combination pumping engine carrying one 100-gallon booster tank, 150 feet of booster hose, 800 feet of 2½-inch hose, 450 feet of 1½-inch hose, 2 short ladders, and fair minor equipment. One 1927 Hahn 300-g.p.m. triple combination pumping engine carrying two 40-gallon booster tanks, 300 feet of booster hose, 750 feet of 2½-inch hose, 500 feet of 1½-inch hose, 2 short ladders and some minor equipment. **Hose:** All 2½-inch hose is C.R.L. with National Standard screw couplings. There is a total supply of 1,700 feet, 150 feet of which is kept in reserve. Drying rack is provided in fire station. Hose is tested at 200 pounds and repacked twice each year. Of the total supply about 20% is more than 5 years old. **Operations:** Department is governed by company by-laws. The chief officer has full control of apparatus and of men at fires and drills. Motors are started at least weekly and at least 4 men are trained to act as drivers and operators for each piece of apparatus. **Drills and Training:** Company drills consisting of pump operation and hose and ladder work are held monthly under the direction of the chief officers. **Fire Methods:** Hand extinguishers, booster and 1½-inch lines are used on incipient fires supported by engine streams with shut-off nozzles. Four all-service gas masks are provided, but salvage covers, flood lighting equipment, and heavy stream appliances are lacking. One mechanical foam set is installed. **Response to Alarms:** Company responds to all local alarms and one piece of apparatus is assigned to outside calls. Outside aid may be secured from the surrounding volunteer departments at Annandale, Clinton, and High Bridge. **Building Inspection:** None by fire department. **Records and Reports:** Records are mainly limited to fire reports including time and nature of alarms and attendance. **Fire Alarms:** Fire alarms are transmitted through a local central office, located in a frame building, to the hotel opposite the fire station and are sounded on siren at fire station.

POLICE DEPARTMENT: Consists of one part-time officer. No vehicles provided. State police constantly patrol this territory.

BUILDING LAWS: Local regulations are limited to an ordinance establishing building lines and set back from street.

FIRE PREVENTION LAWS: No local regulations. State laws adequately cover the storage and shipment of explosives and flammables and the construction of motion picture booths. They also restrict the discharge of fireworks to responsible bonded parties.