

Superseding Map No. 336 of July, 1937.  
Please destroy old issue.

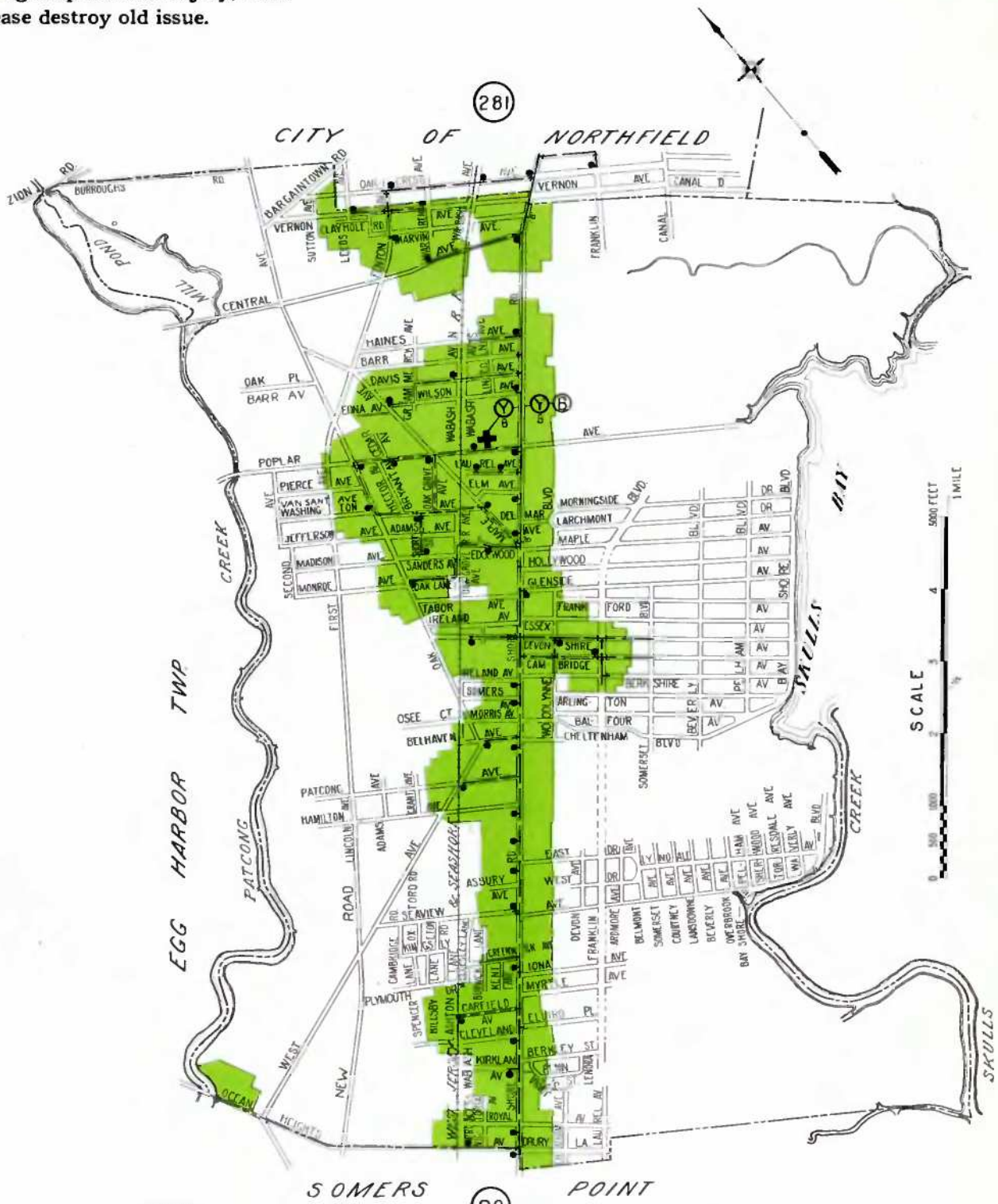

**KEY**

**PROTECTED FIRE ZONE:** Shown in Green.

**NOTE.**—For description of fire protection, etc., see other side.

Elevations range from 0 to 32 feet above mean sea level.

Water mains 8 inches and larger in diameter

Water mains 6 inches in diameter

Water mains 4 inches in diameter

Fire hydrants shown thus

Gate valves shown thus

Fire house shown thus

Fire apparatus designated by symbols thus:

Ⓨ Pumping engine and hose car

Ⓟ Booster car

Ⓞ Booster tank or tanks on above



**THE FIRE INSURANCE RATING  
ORGANIZATION OF N. J.  
ENGINEERING DEPARTMENT  
NEWARK 2, N. J.**

**City of Linwood  
Atlantic County, N. J.**

MARCH 31, 1949

**CITY OF LINWOOD, ATLANTIC COUNTY, NEW JERSEY.**

**Population — 1940 Census — 1,479.**

**IN GENERAL:** Located on the Pennsylvania Reading Seashore Lines between Pleasantville and Somers Point. Principally a residential community with no manufacturing. Main streets paved, in generally good condition; other roads are gravel in fairly good condition. Area about 4.25 square miles; elevations range from 0 to 32 feet above mean sea level. Grade crossings reported as not having interfered with response of fire apparatus.

**WATER SUPPLY:** Water for domestic and fire protection purposes is supplied by the Atlantic County Water Company. For detailed description see report and map of Pleasantville No. 89. **Distribution System:** In one service; see map and description above. Arteries consist of 8-inch to 6-inch with incomplete 4-inch and 6-inch gridiron. **Consumption:** The average and maximum daily consumption for the entire territory served (about 4,987 services) during 1946 was 0.826 and 1.486 m.g.d. On December 31, 1947 there were 394 services in Linwood, all of which were metered. **Pipe:** All pipe is cast iron, tar coated, with bell and spigot joint, laid with about a 4-foot cover. No recent trouble from electrolysis or frozen mains. Total length, 38,783 feet; 13% 8-inch, 77% 6-inch, and 10% 4-inch. **Gate Valves:** There are 46 in Linwood with iron boxes at grade. Operating direction is not uniform. Record is kept of operation. Valves are inspected annually. Fire department notified when valves affecting hydrant supply are operated. **Hydrants:** There are 42 of Ludlow and Corey makes, 11 of which have 4-inch barrel and branch and others have 6-inch barrel and branch. All have 3 outlets and 30 have gated branch. They are inspected after use and twice annually. All outlets have National Standard threads. **Pressures:** Readings taken at 2 hydrants showed an average pressure of 40 pounds. **Fire Flow Tests:** Probable supply available for fire protection purposes was measured on June 24, 1948 by means of Pitot tube. Location of hydrant, discharge in gallons per minute, pressure before flow, and pressure during flow were as follows:

Ocean Heights Ave. and Shore Rd., 300—39—3½.

Elm Ave. and Shore Rd., 530—42—10.

**FIRE DEPARTMENT:** A volunteer organization under control of the city with two paid drivers working 24-hour shifts. Total membership about 100, of whom 16 are available at all times. There are a chief, 2 assistant chiefs, foreman, and assistant foreman. City owns all apparatus and equipment; company owns house. Officers are elected by the

company and confirmed by the mayor and council. **Company:** Located on Poplar Avenue between Shore Road and the railroad, in a one-story frame building with slag roof, wood floor, hot water heat, electric lights, and two telephones. **Equipment:** One 1930 Hahn 500-g.p.m. triple combination pumping engine carrying a 150-gallon booster tank, 200 feet of booster hose, 300 feet of 1½-inch hose, 1,300 feet of 2½-inch hose, two short ladders, 2 gas masks, 2 salvage covers, and fair minor equipment. A 1948 Oren-Diamond "T" 500-g.p.m. triple combination pumping engine carrying a 500-gallon booster tank, 150 feet of booster hose, 200 feet of 1½-inch hose, 1,000 feet of 2½-inch hose, 2 short ladders, one 1,500-watt electric generator, 3 flood lights, and fair minor equipment. A 1931 Chevrolet 100-g.p.m. booster car carrying a 500-gallon booster tank, 150 feet of booster hose, 300 feet of 1½-inch hose, and meager minor equipment. **Hose:** All 2½-inch hose is C.R.L. with National Standard screw couplings. There is a total supply of 2,900 feet, of which 2,400 feet is over 7 years old and 900 feet is in reserve. It is shifted about three times a year and tested annually at 100 pounds. **Operations:** Governed by company by-laws. Chief has control of apparatus at all times and of men at fires and drills. He has no power to suspend members, but may prefer charges to the company. Motors are started daily and about 21 men can operate the apparatus. **Drills and Training:** Chief drills company twice monthly in handling hose and ladders. **Fire Methods:** Booster streams used on small fires reinforced by engine lines. **Response to Alarms:** Entire department responds to all alarms. Aid may be secured from a number of nearby communities. **Building Inspection:** None. **Records and Reports:** Record of fires is kept and yearly report is made to mayor and council. **Fire Alarms:** Alarms are telephoned to fire house and coded signal is sounded on siren and air horn on city hall adjoining the fire station.

**POLICE DEPARTMENT:** There are a chief, 1 patrolman, and 13 special officers. An automobile is provided.

**BUILDING LAWS:** It was reported at the time of inspection that a building code was in force, but copies were not available and provisions of the code are not known.

**FIRE PREVENTION LAWS:** No municipal regulations. State laws adequately cover the storage and shipment of explosives, the transportation of flammables, and the construction of motion picture booths. They also restrict the discharge of fireworks to responsible bonded parties.