

29-29

HUDSON RIVER

11

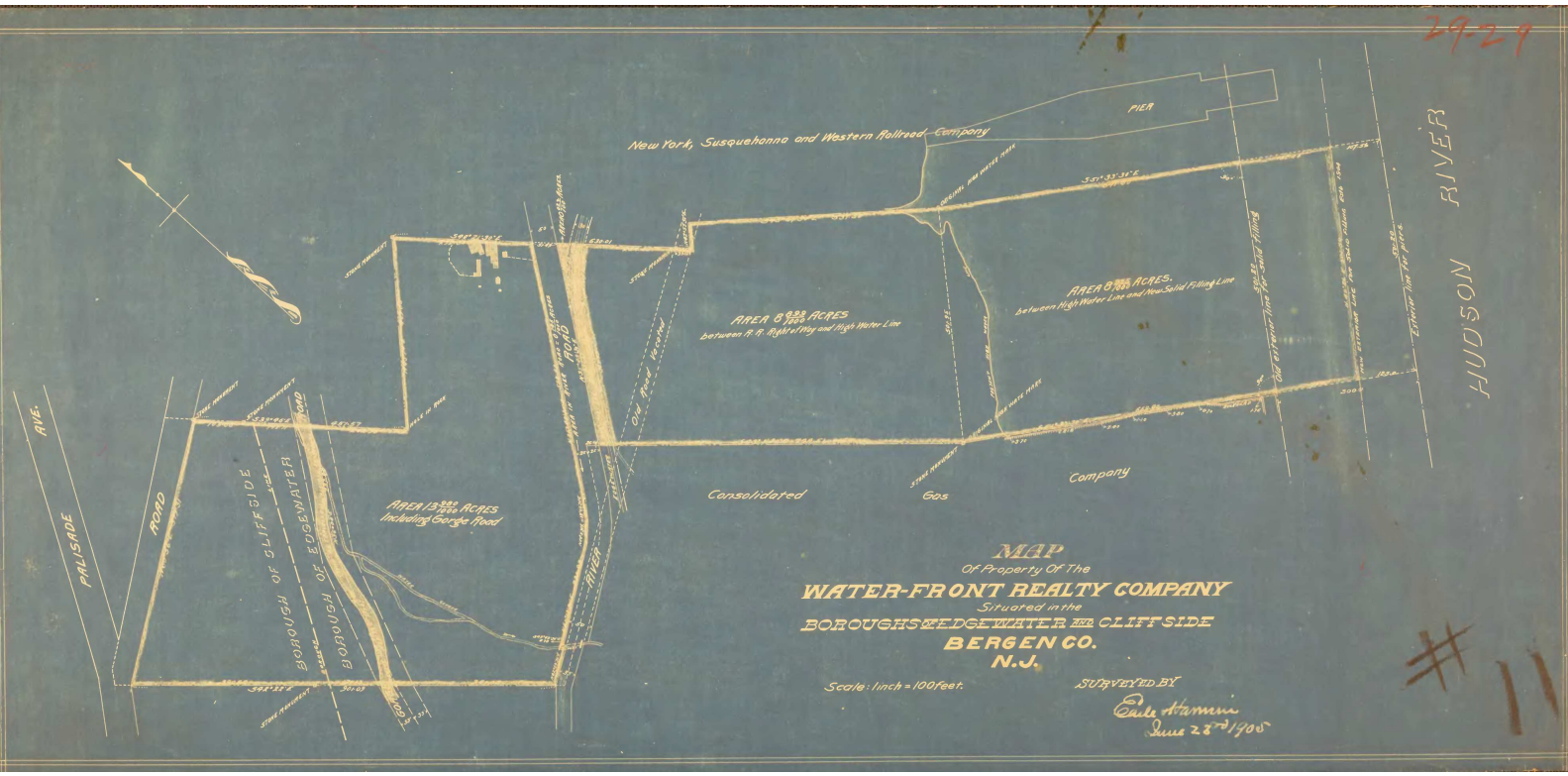

New York, Susquehanna and Western Railroad Company

PIER

AREA 6,900 ACRES
Between A. B. Right-of-Way and High Water Low

AREA 8,000 ACRES
Between High Water Line and Proposed Filling Line

AREA 13,000 ACRES
Including George Flood

Consolidated

Gas

Company

MAP
Of Property Of The
WATER-FRONT REALTY COMPANY
Situated in the
BOROUGH OF EDGEWATER AND CLIFFSIDE
BERGEN CO.
N. J.

Scale: 1 inch = 100 feet.

SUBMITTED BY

Edie Harmon
June 23, 1905