

29-18a

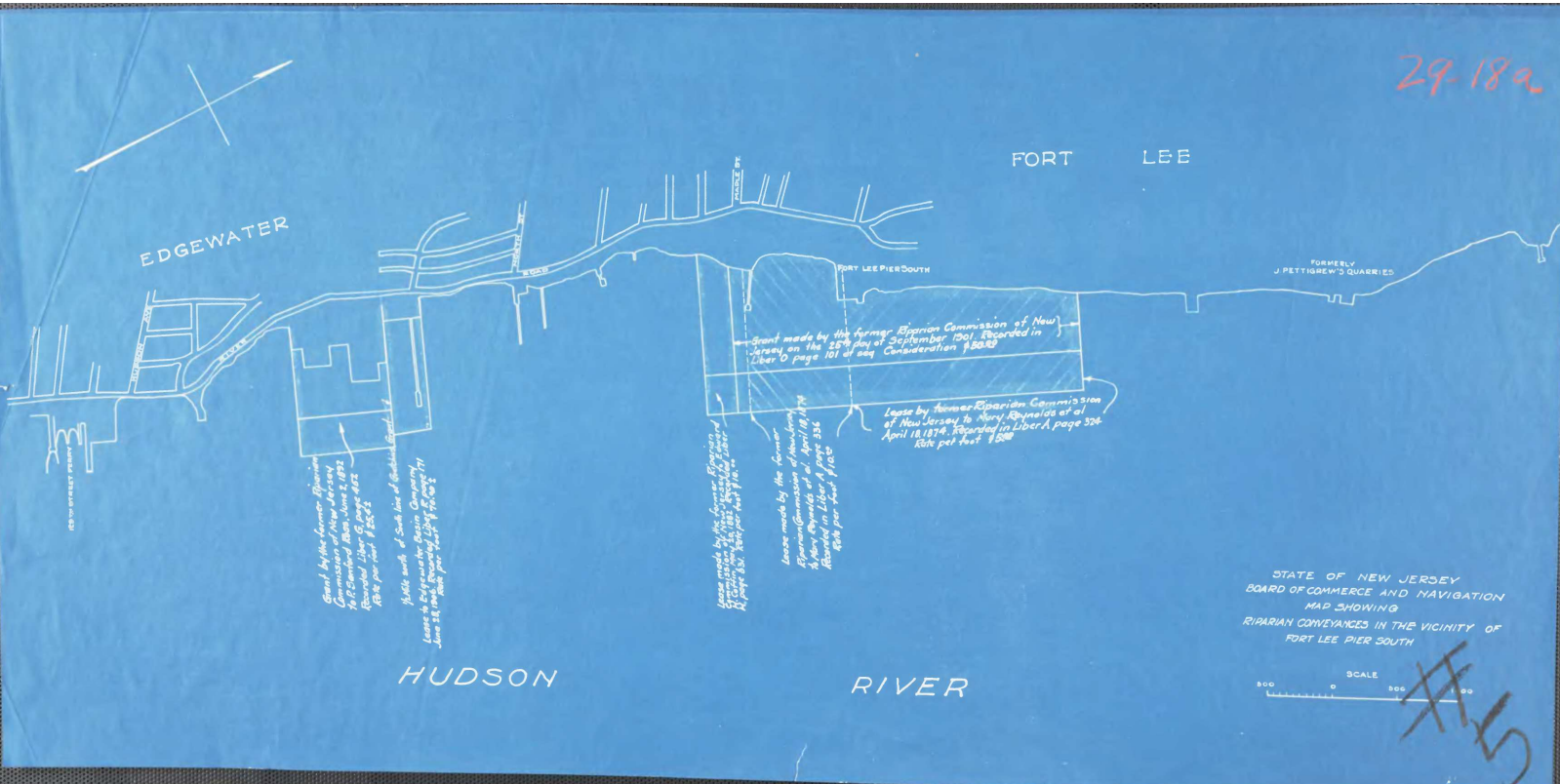

EDGEWATER

FORT LEE

FORT LEE PIER SOUTH

FORMERLY J. PETTIBREW'S QUARRIES

Grant by the former Riparian Commission of New Jersey to J.P. Crawford 1826, recorded in Liber D page 422. 18th per foot \$150.00.

1/4th north of South line of Edgewater Pier.

Lease by the former Riparian Commission of New Jersey to the Basin Company June 24, 1827, recorded in Liber D page 411. 18th per foot \$150.00.

Grant made by the former Riparian Commission of New Jersey to the Basin Company April 18, 1827, recorded in Liber D page 411. 18th per foot \$150.00.

Lease made by the former Riparian Commission of New Jersey to the Basin Company April 18, 1827, recorded in Liber A page 335. 18th per foot \$150.00.

Grant made by the former Riparian Commission of New Jersey on the 25th day of September 1801, recorded in Liber D page 101 of my Consideration \$800.00.

Lease by the former Riparian Commission of New Jersey to Mary Reynolds et al April 11, 1834, recorded in Liber A page 526. 18th per foot \$150.00.

STATE OF NEW JERSEY
BOARD OF COMMERCE AND NAVIGATION
MAP SHOWING
RIPARIAN CONVEYANCES IN THE VICINITY OF
FORT LEE PIER SOUTH

SCALE
0 500 1000

Handwritten signature/initials