

MAP OF RIPARIAN & LANDS UNDER WATER ABOUT TO BE ACQUIRED BY THE UNITED STATES ALUMINUM CO. AT EDGEWATER BERGEN CO., N.J. JULY 1914

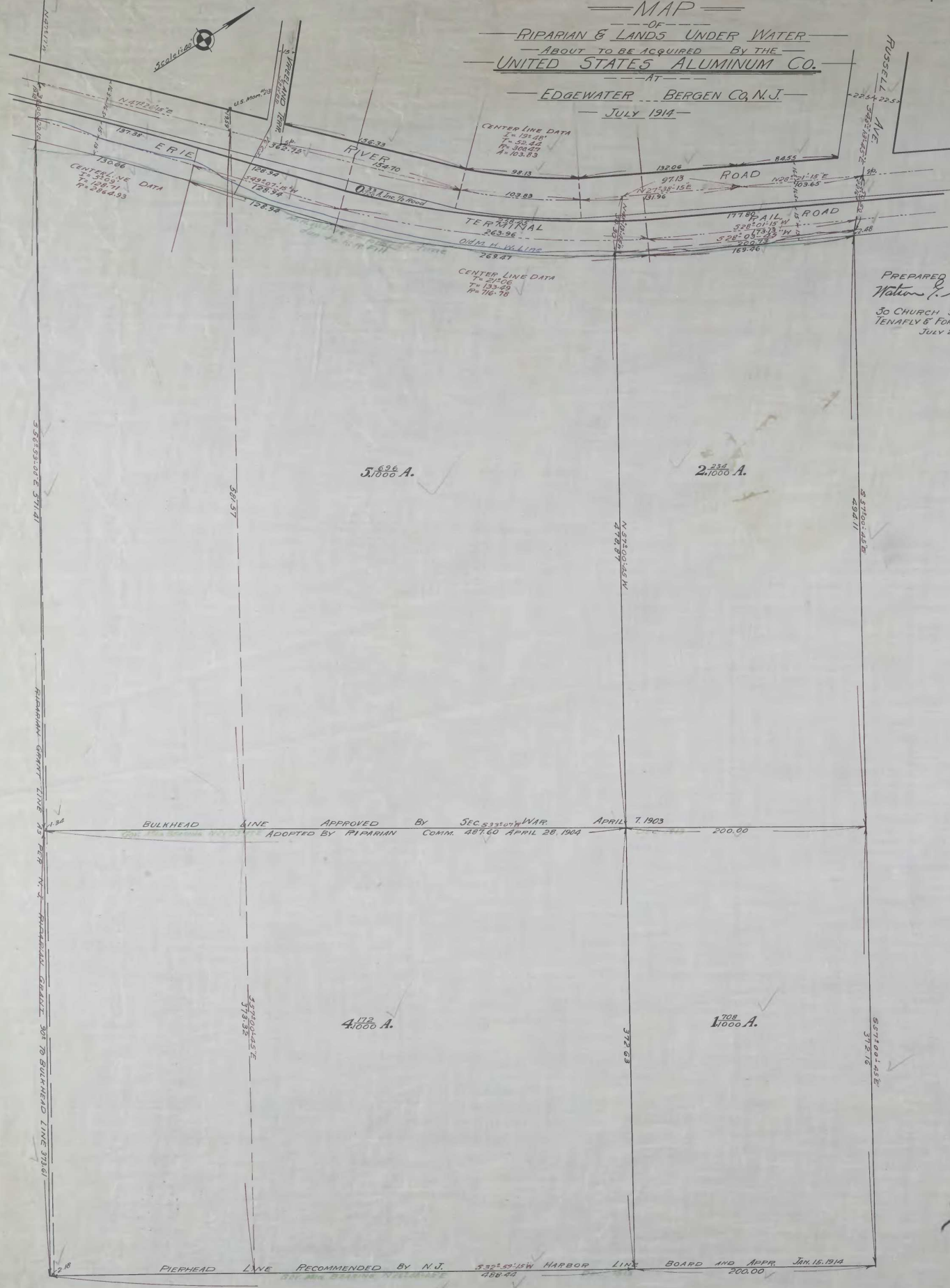

PREPARED BY Watson & Clark C.E. 30 CHURCH ST. N.Y.C. TENAFLY & FORT LEE N.J. JULY 28, 1914

BULKHEAD LINE APPROVED BY SEC. OF WAR APRIL 7, 1903 ADOPTED BY RIPARIAN COMM. 40760 APRIL 28, 1904 200.00

PIERHEAD LINE RECOMMENDED BY N.J. 5222-69-15W HARBOR LINE BOARD AND APPR. JAN. 15, 1914 200.00

HUDSON RIVER

2475 C
F.A.
D.W.
A.D.

29-27