

BERGEN COUNTY

CITY OF GARFIELD

BOROUGH OF WALLINGTON

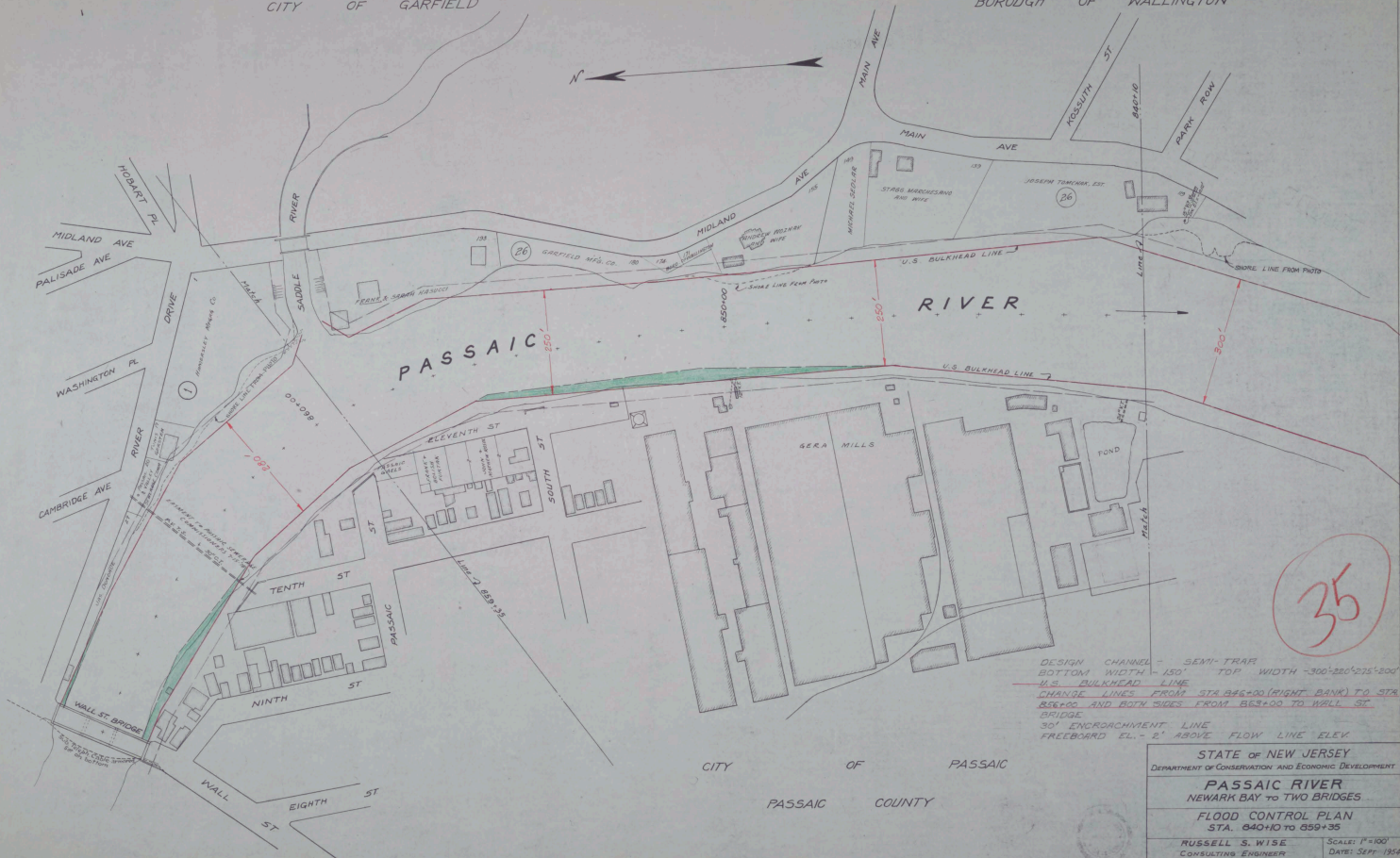
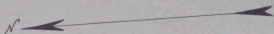

DESIGN CHANNEL - SEMI-TRAP
 BOTTOM WIDTH - 150' TOP WIDTH - 300'-220'-215'-200'
 U.S. BULKHEAD - LINE
 CHANGE LINES FROM STA 845+00 (RIGHT BANK) TO STA
 856+00 AND BOTH SIDES FROM 863+00 TO WALL ST
 BRIDGE
 30' ENCROACHMENT LINE
 FREEBOARD EL. - 2' ABOVE FLOW LINE ELEV

CITY OF PASSAIC

PASSAIC COUNTY

STATE OF NEW JERSEY
DEPARTMENT OF CONSERVATION AND ECONOMIC DEVELOPMENT

PASSAIC RIVER
NEWARK BAY TO TWO BRIDGES

FLOOD CONTROL PLAN
STA. 840+00 TO 859+35

RUSSELL S. WISE SCALE: 1"=100'
CONSULTING ENGINEER DATE: 3/27/1954
1051 BLOOMFIELD AVE. CLIFTON, N.J. SHEET 24 OF 56