

CABINET A  
ARM NO. 31  
FOLDER NO. \_\_\_\_\_  
SHEET NO. 12.8

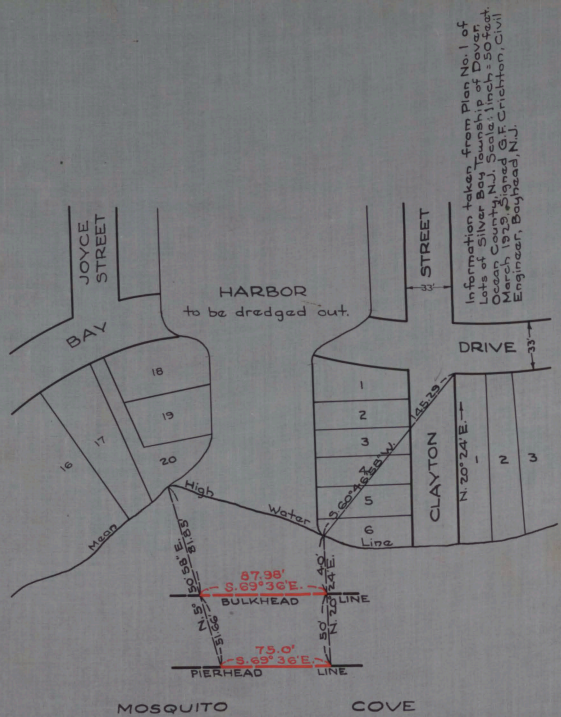
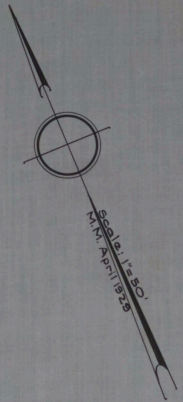

Information taken from Plan No. 1 of Lots of County, Township of Dover, March 1923, signed G.F. Chilton, Civil Engineer, Bayhead, N.J.

NO 325  
STATE OF NEW JERSEY  
BOARD OF COMMERCE AND NAVIGATION  
MAP SHOWING  
PIERHEAD LINE AND BULKHEAD LINE  
ON MOSQUITO COVE IN THE  
TOWNSHIP OF DOVER IN THE  
COUNTY OF OCEAN  
ADOPTED FEBRUARY 18, 1931.

- JSS. *James Smith*
- WTK. *William T. Kirk*
- AS. *Augustus Smith*
- FD. *Frank Derry*
- JM. *James M. ...*
- JWC. *James W. ...*

Attest:

*Victor Beliveau*  
DIRECTOR AND CHIEF ENGINEER