

CABINET A
SERIAL NO. 31
FOLDER NO. 1
DATE 1/59

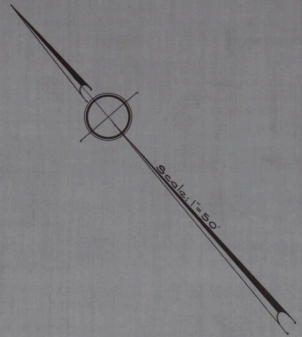

NO. 360
STATE OF NEW JERSEY
BOARD OF COMMERCE AND NAVIGATION
MAP SHOWING
PIERHEAD LINE AND BULKHEAD LINE
ON MANAHAWKEN BAY
IN THE BOROUGH OF SHIP BOTTOM-
BEACH ARLINGTON IN THE
COUNTY OF OCEAN
ESTABLISHED JULY 20, 1931.

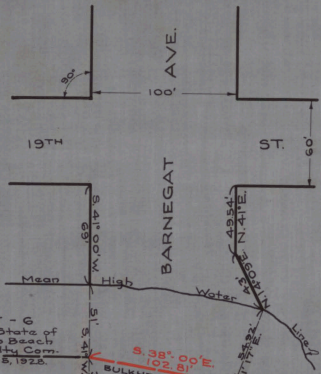

TRACT - G
Grant by the State of
New Jersey to Beach
Arlington Realty Com-
pany October 18, 1928.

BULKHEAD LINE
S 38° 00' E
102.51' E

PIERHEAD LINE
S 26° 30' E
81.63' E

MANAHAWKEN BAY

S. J. Spence
K. Williams
H. S. Carpenter
M. J. ...
J. ...
J. ...

Attest:

Victor Delmon
DIRECTOR AND CHIEF ENGINEER

10.523