

DELAWARE RIVER

BACK CHANNEL

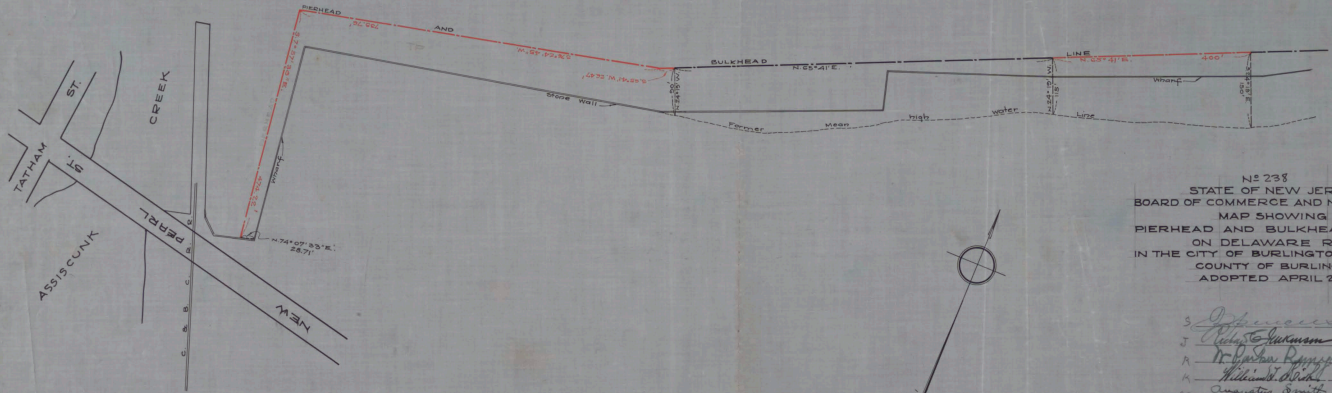

No 238
 STATE OF NEW JERSEY
 BOARD OF COMMERCE AND NAVIGATION
 MAP SHOWING
 PIERHEAD AND BULKHEAD LINE
 ON DELAWARE RIVER
 IN THE CITY OF BURLINGTON IN THE
 COUNTY OF BURLINGTON
 ADOPTED APRIL 25, 1927.

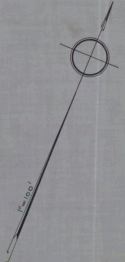

- S. *Joseph Smith*
- J. *Johnston*
- R. *Richard Johnson*
- K. *William Smith*
- AS *Augustus Smith*
- Harrison Fox*

CABINET A
 ARM NO. 31
 FOLDER NO. _____
 SHEET NO. 54

ATTEST:
Victor Nelson
 DIRECTOR AND CHIEF ENGINEER