

WEST CREEK

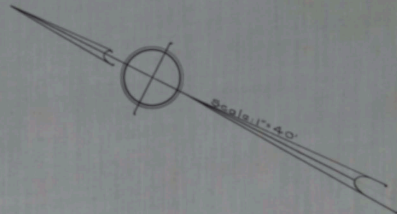
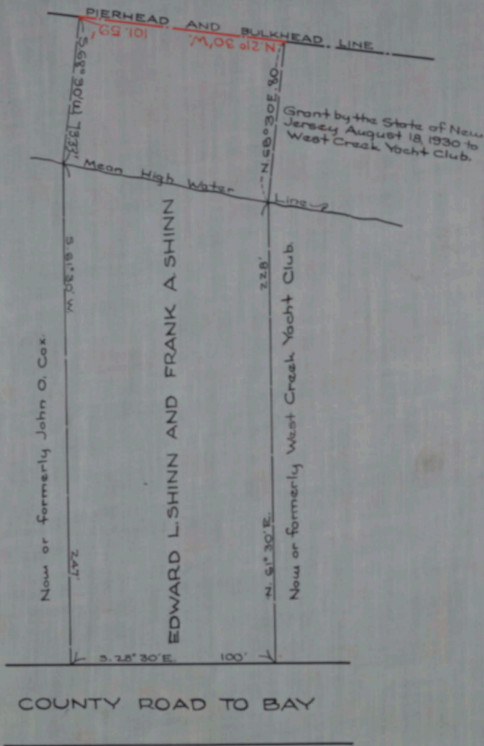

No. 383
 STATE OF NEW JERSEY
 BOARD OF COMMERCE AND NAVIGATION
 MAP SHOWING
 PIERHEAD AND BULKHEAD LINE
 ON WEST CREEK
 IN THE TOWNSHIP OF EAGLEWOOD IN THE
 COUNTY OF OCEAN
 ESTABLISHED DECEMBER 21, 1931

3 *Spencer Smith*
 13 *Augustus Smith*
Wright
Frank
John
H. B.

CABINET A
 ARM NO. 32
 FOLDER NO.
 SHEET NO. 6

Attest:

Victor L. Lincoln
 DIRECTOR AND CHIEF ENGINEER