

CRANMOOR DRIVE

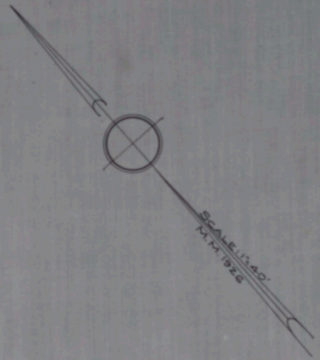
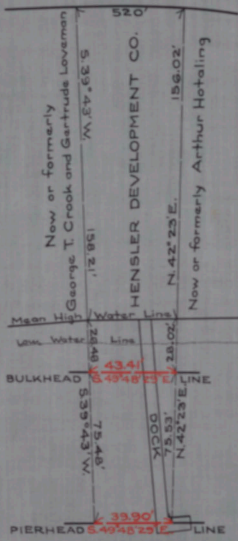

NO. 429
 STATE OF NEW JERSEY
 BOARD OF COMMERCE AND NAVIGATION
 MAP SHOWING
 PIERHEAD AND BULKHEAD LINES
 ON TOMS RIVER
 IN THE TOWNSHIP OF DOVER IN THE
 COUNTY OF OCEAN
 ESTABLISHED NOVEMBER 21, 1932

- S *Phenice Smith*
- M *John Daniels*
- D *John Perry*
- C *Joseph Pagella*
- K *H. H. Elliot*
- K *James J. Kelly*
- W. S. Mes*

CABINET A
 ARM NO. 32
 FOLDER NO.
 SHEET NO. 50

ATTEST-
Victor Beliveau
 Director and Chief Engineer