

N. 67° 03' W.  
Property Line

CERAMIC PRODUCTS COMPANY

2 Stone Monument  
Property Line  
N. 85° 57' E.

SOUTH RIVER SAND CO.

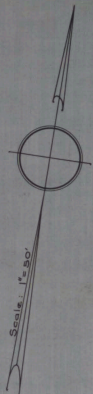

Lease by the State of New Jersey  
September 27, 1926, to South River  
Sand Co.

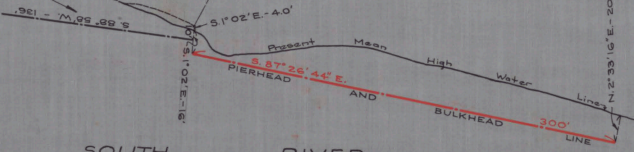

SOUTH RIVER

NO. 419  
STATE OF NEW JERSEY  
BOARD OF COMMERCE AND NAVIGATION  
MAP SHOWING  
PIERHEAD AND BULKHEAD LINE  
ON SOUTH RIVER  
IN THE TOWNSHIP OF EAST BRUNSWICK IN THE  
COUNTY OF MIDDLESEX  
ESTABLISHED SEPTEMBER 19, 1932

5 *Spencer Smith*  
M. *John Hamilton*  
*James Conover*  
*Boyle & Gillett*  
*Joe H. Kelly*  
*H.S. Ross*

CABINET     A      
ARCH NO.     32      
FOLDER NO.       
SHEET NO.     41    

ATTEST  
*Victor Beltrian*  
Director and Chief Engineer