

New York Bay the right to solid fill or the erection of any structures whatsoever in the area between the Bulkhead Line and the Pierhead Line Adopted by the Assistant Secretary of War Oct. 30, 1918, shall be subject to the regulations of and the approval by the Secretary of War.

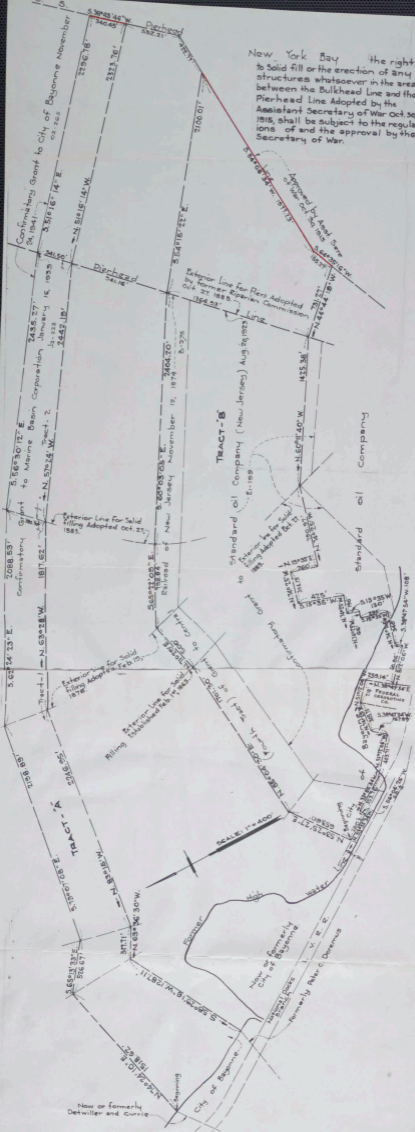

NO. 493
 STATE OF NEW JERSEY
 DEPARTMENT OF CONSERVATION
 DIVISION OF NAVIGATION
 MAP SHOWING
 PIERHEAD LINE
 ON NEW YORK BAY, IN THE CITY OF
 BAYONNE, COUNTY OF HUDSON
 ADOPTED NOVEMBER 18, 1946.

- 1. *James H. ...*
- 2. *...*
- 3. *...*
- 4. *...*
- 5. *...*
- 6. *...*