

SHARK RIVER

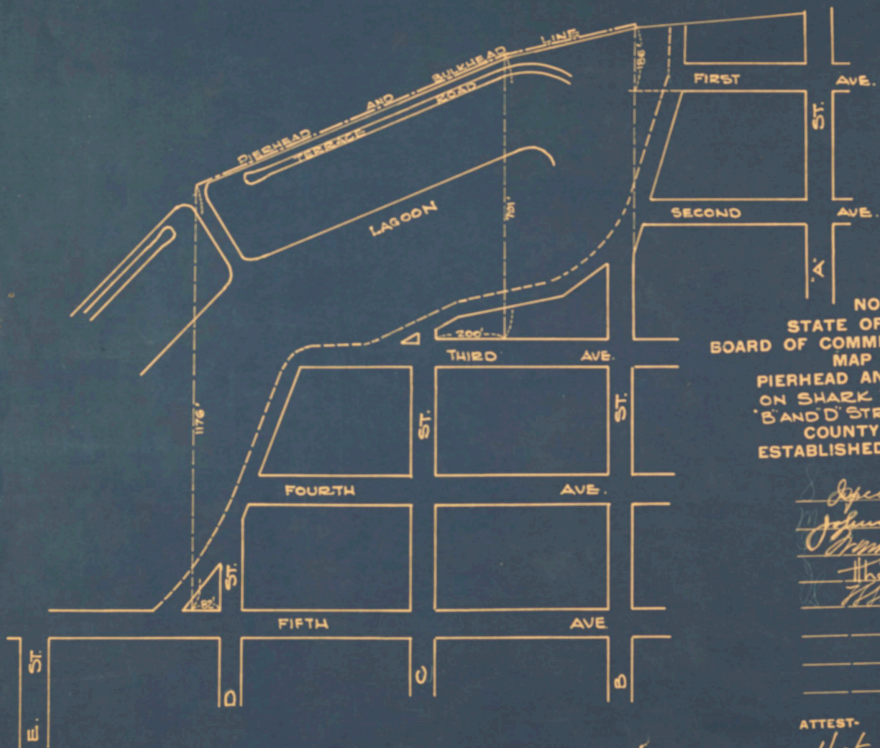

NO 458
 STATE OF NEW JERSEY
 BOARD OF COMMERCE AND NAVIGATION
 MAP SHOWING
 PIERHEAD AND BULKHEAD LINE
 ON SHARK RIVER BETWEEN
 'B AND 'D' STREETS BOROUGH BELMAR
 COUNTY OF MONMOUTH
 ESTABLISHED DECEMBER 1, 1936

Jessie Smith
John ...
Tom ...
Thos ...
Blair

ATTEST:
Victor ...
 Director and Chief Engineer