

WAR DEPARTMENT

CORPS OF ENGINEERS, U.S. ARMY

1-1 ACCOYWAY FILING TITLE

1-4 ACCOYWAY FILING TITLE

1-4 ACCOYWAY FILING TITLE

1-4 ACCOYWAY FILING TITLE

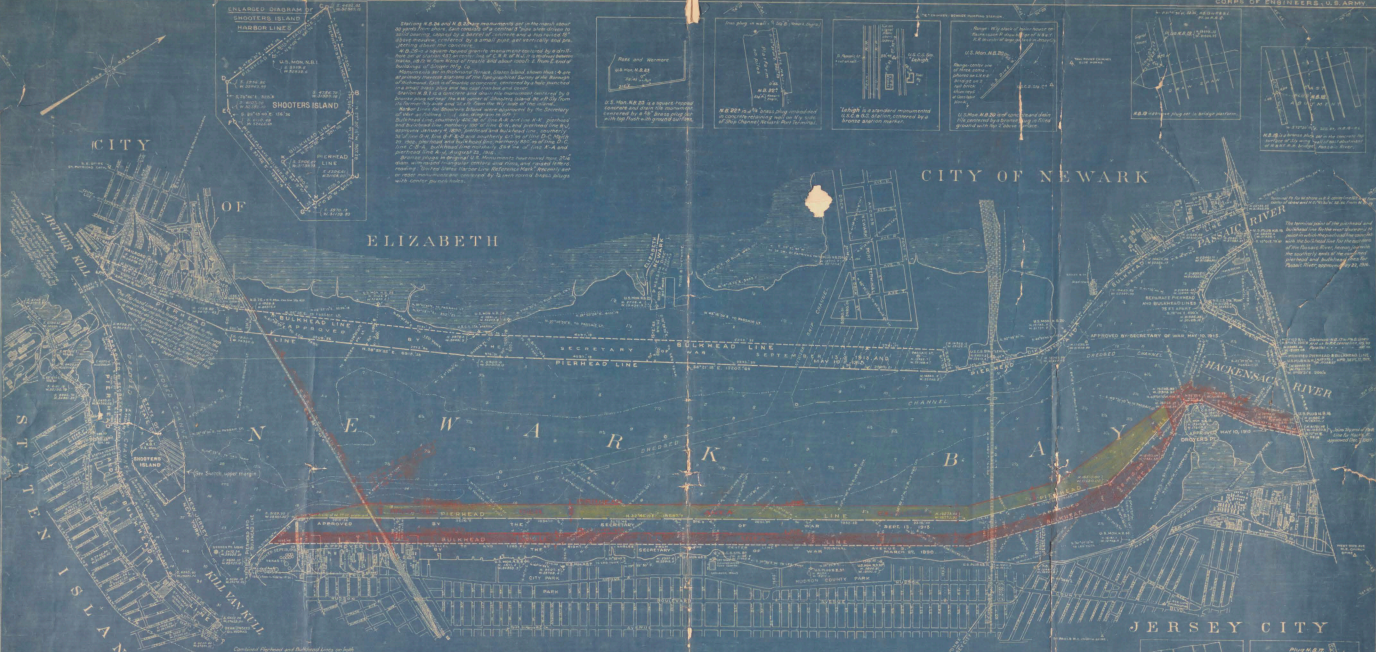

Showing the location of the bulkhead and pierhead lines and the location of the various structures on the island. The island is bounded by the Passaic River to the north and the Hackensack River to the south. The bulkhead line is shown as a dashed line, and the pierhead line is shown as a solid line. The island is divided into several sections, each with its own set of structures and survey lines.

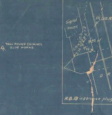
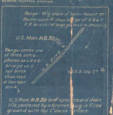
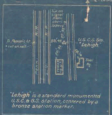

CITY

OF

ELIZABETH

CITY OF NEWARK

JERSEY CITY

NEWARK BAY

ELIZABETH

CITY OF BAYONNE

JERSEY CITY

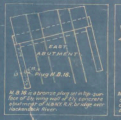
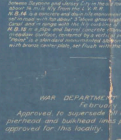
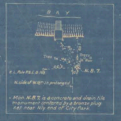
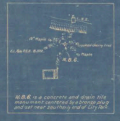
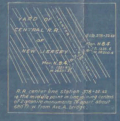

NOTE
This plan is a reproduction of the original plan of the pier structure, and is not intended to be used as a basis for construction. The original plan is on file in the office of the Chief of Engineers, U.S. Army, New York City.

NOTE
The plan of the pier structure is shown in this plan, and is not intended to be used as a basis for construction. The original plan is on file in the office of the Chief of Engineers, U.S. Army, New York City.

NOTE
The plan of the pier structure is shown in this plan, and is not intended to be used as a basis for construction. The original plan is on file in the office of the Chief of Engineers, U.S. Army, New York City.

NOTE
The plan of the pier structure is shown in this plan, and is not intended to be used as a basis for construction. The original plan is on file in the office of the Chief of Engineers, U.S. Army, New York City.

NOTE
The plan of the pier structure is shown in this plan, and is not intended to be used as a basis for construction. The original plan is on file in the office of the Chief of Engineers, U.S. Army, New York City.

NOTE
The plan of the pier structure is shown in this plan, and is not intended to be used as a basis for construction. The original plan is on file in the office of the Chief of Engineers, U.S. Army, New York City.

NOTE
The plan of the pier structure is shown in this plan, and is not intended to be used as a basis for construction. The original plan is on file in the office of the Chief of Engineers, U.S. Army, New York City.

NOTE
The plan of the pier structure is shown in this plan, and is not intended to be used as a basis for construction. The original plan is on file in the office of the Chief of Engineers, U.S. Army, New York City.

NOTE
The plan of the pier structure is shown in this plan, and is not intended to be used as a basis for construction. The original plan is on file in the office of the Chief of Engineers, U.S. Army, New York City.

WAR DEPARTMENT
Approved: _____
Secretary of War

PIERHEAD AND BULKHEAD LINES
FOR ALL SHORES OF
NEWARK BAY, NEW JERSEY
SCALE 1:5000

Office of the New York Harbor Pilot, New York City
Approved: _____
Chief of Pilots

Approved: _____
Secretary of War

12